

THIS DOCUMENT IS THE PROPERTY OF KEYSTONE ELECTRONICS CORP. AND SHALL NOT BE REPRODUCED, DISTRIBUTED OR USED AS A BASIS FOR MANUFACTURE WITHOUT PRIOR WRITTEN PERMISSION FROM KEYSTONE ELECTRONICS CORP.

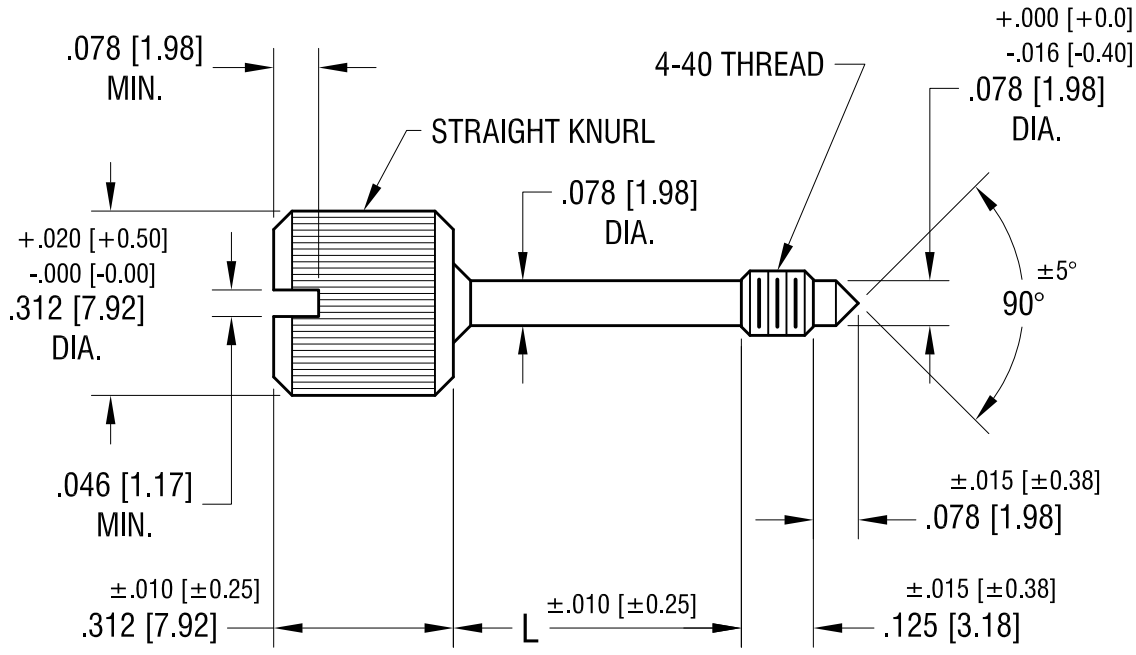
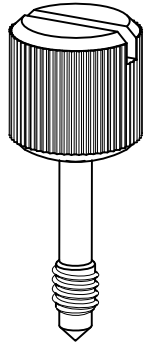

PART NO.	'L' DIM.
8706	.171 [4.34]
8707	.296 [7.52]
8708	.421 [10.69]

DATE	DESCRIPTION	REV.
9.24.09	CHANGE AS PER ECN 09-135	B
7.15.08	CHANGE AS PER ECN 08-125	A

KEYSTONE ELECTRONICS CORP.
 www.keyelco.com • ASTORIA, N.Y. 11105-2017 • Tel (718) 956-8900

PART NAME: CAPTIVE PANEL SCREW

MATERIAL: STAINLESS STEEL

FINISH: -

DRN BY: BOONE DATE: 12.12.95

APP'D: SCALE: 3X

TOLERANCES INCH [MM]: DECIMAL $\pm .005$ [± 0.15]

ANGULAR $\pm 1^\circ$ UNLESS OTHERWISE SPECIFIED

CODE: C DWG NO.: 8706-8708