

LOC	DIST	REVISIONS			
P	LTN	DESCRIPTION	DATE	DWN	APVD
FT	13	K	063B-035B-03	02MAY03	TK GS

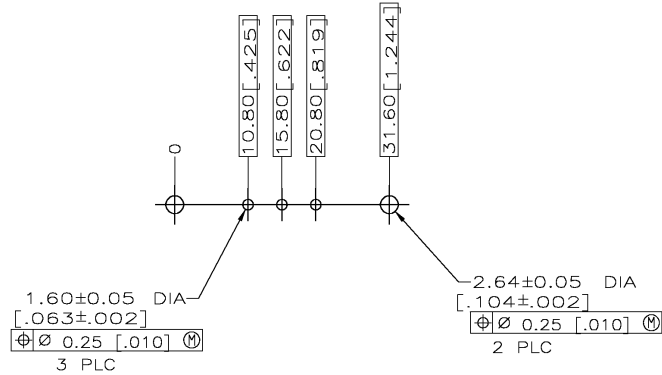

RECOMMENDED PC BOARD LAYOUT

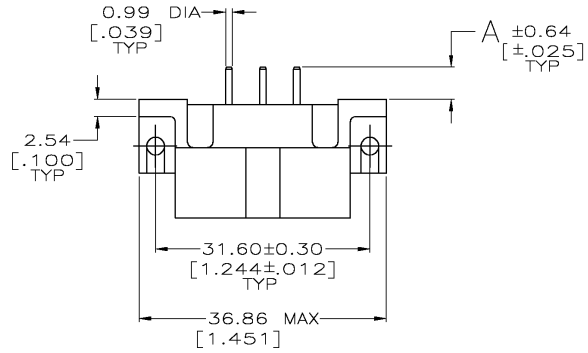
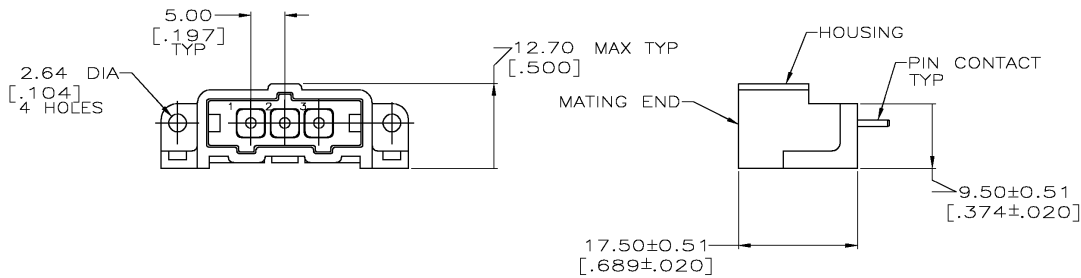

- ▲ NYLON, RED.
- ▲ BRASS PER ASTM B36.
- ▲ 3.81µm [0.000150] MIN TIN-LEAD OVER 2.54µm [0.000100] MIN COPPER OR 1.27µm [0.000050] MIN NICKEL.
- ▲ 0.76µm [0.000030] MIN GOLD FOR A LENGTH OF 5.08 [0.200] MIN FROM MATING END, 3.81µm [0.000150] MIN TIN-LEAD FOR A LENGTH OF 5.36 [0.211] MIN FROM OPPOSITE END, BOTH OVER 1.27µm [0.000050] MIN NICKEL.
- ▲ .000150 MIN TIN OVER .000100 MIN CU, OR .000050 MIN NICKEL.

4.72 [0.186]	▲5	207365-7
7.52 [0.296]	▲4	207365-6
4.72 [0.186]	▲4	207365-3
4.72 [0.186]	▲3	207365-1
A	FINISH	PART NUMBER

THIS DRAWING IS A CONTROLLED DOCUMENT.		DWN L SIPE 07/20/92	Tyco Electronics Corporation Harrisburg, Pa																			
DIMENSIONS: INCHES		CHK R STONE 7-24-92	APVD A TRAVIS 7-24-92																			
TOLERANCES UNLESS OTHERWISE SPECIFIED:		NAME A TRAVIS																				
<table border="1"> <tr><td>0 PLC</td><td>±</td><td>-</td></tr> <tr><td>1 PLC</td><td>±</td><td>-</td></tr> <tr><td>2 PLC</td><td>±</td><td>0.25 [0.010]</td></tr> <tr><td>3 PLC</td><td>±</td><td>-</td></tr> <tr><td>4 PLC</td><td>±</td><td>-</td></tr> <tr><td>ANGLES</td><td>±</td><td>-</td></tr> </table>		0 PLC	±	-	1 PLC	±	-	2 PLC	±	0.25 [0.010]	3 PLC	±	-	4 PLC	±	-	ANGLES	±	-	PRODUCT SPEC APPLICATION SPEC		
0 PLC	±	-																				
1 PLC	±	-																				
2 PLC	±	0.25 [0.010]																				
3 PLC	±	-																				
4 PLC	±	-																				
ANGLES	±	-																				
MATERIAL HOUSING: 1	FINISH CONTACTS: SEE TBL	WEIGHT -	SIZE A2	00779 ©-207365																		
CUSTOMER DRAWING		SCALE 4:1	SHEET 1	OF 1																		
		REV K	RESTRICTED TO																			

207365